

# G.T.ROAD AMRITSAR

Figure 1 Subject Property



Figure 2 Approach Road



*Figure 3 Side Abutting Bridge*

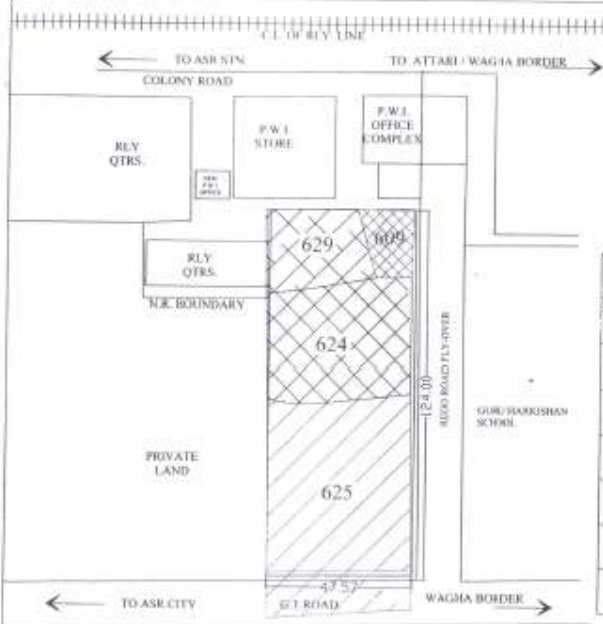

*Figure 4: Rear View of property*



AREA WISE REVENUE MAP DETAILS OF PROPOSED RAILWAY LAND FOR CHANGE OF LAND USE TO COMMERCIAL / HOTEL AT G.T. ROAD AMRITSAR ( AREA= 5865.20)

ANNEXURE-C



LEGENDS:-

Area wise details for change of land use.					
Khasra No.	Existing Area.	Proposed Area for CLU	Present Use	Proposed for use	Showa thus
624	2Kanal,16 Marla (1416.39 Sqm)	1416.39 Sqm	Railway	Commercial Hotel	
625 Part	6Kanal,8Marla (3237.00 Sqm)	2579.00 Sqm	Railway	Commercial Hotel	
625 Part	Part area used in road widening in G.T. Road. Area =658.00 Sqm				
629 Part	353kanal,19Marla	1186.00 Sqm	Railway	Commercial Hotel	
609 Part	140Kanal,13Marla	683.81 Sqm	Railway	Commercial Hotel	
<b>Total =</b>		<b>5865.20 Sqm</b>			

**RAIL LAND DEVELOPMENT AUTHORITY**  
(GOVT. OF INDIA, MINISTRY OF RAILWAY)



KMREUP	MANAGER REUP	PATWARI / CONSULTANT	DRAUGHTSMAN / RLDA